

# Franklyn James



598 Commercial Road

, London, E14 7JR

£2,000 Per Calendar Month

This beautifully presented one-bedroom apartment offers breathtaking south-facing views over Limehouse Marina and the Canary Wharf skyline. The bright, open-plan living space features a modern kitchen with an integrated dining area, while floor-to-ceiling windows flood the interior with natural light and lead to a spacious private balcony. The large double bedroom includes a king-size bed and ample fitted storage, while a sleek bathroom and additional storage throughout provide both comfort and convenience.

Premium features include underfloor heating, dimmable mood lighting, built-in speakers, and real wooden flooring, complemented by high-quality, versatile furnishings like an extendable dining table and a sofa bed. Residents also enjoy a daytime porter, secure entry, lift access, and bike storage. With excellent transport links via Limehouse DLR and Shadwell Overground, this stylish apartment offers luxury, comfort, and connectivity in a prime waterside location.

- South-facing with breathtaking marina & skyline views
- Underfloor heating & real wooden flooring
- Built-in speakers & dimmable mood lighting
- Secure entry, lift access & bike storage
- Private balcony

Viewing

Please contact our Limehouse Lettings Office on 02077911777 if you wish to arrange a viewing appointment for this property or require further information.



1



1



1

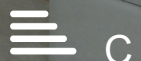

C

Franklyn  
James



Floor Plan

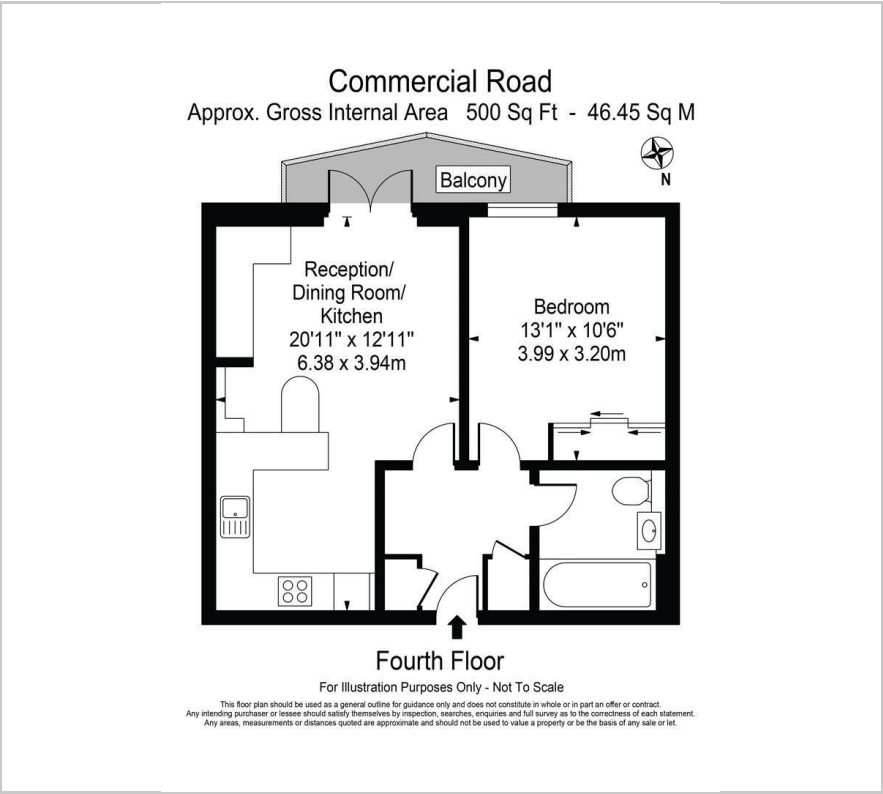

Area Map



Energy Efficiency Graph

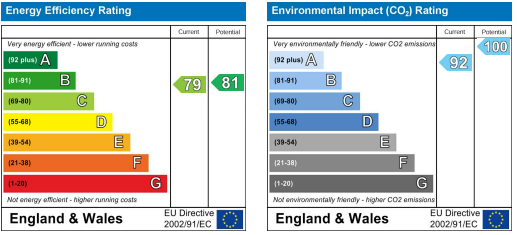

These particulars, whilst believed to be accurate are set out as a general outline only for guidance and do not constitute any part of an offer or contract. Intending purchasers should not rely on them as statements of representation of fact, but must satisfy themselves by inspection or otherwise as to their accuracy. No person in this firm's employment has the authority to make or give any representation or warranty in respect of the property.